

ElkStooth



July-August, 2008

www.elkstooth.com

All-American Lodge
1998-2004 State Award

INSIDE:

- July-Aug. Meetings ... 2
- Lodge of Sorrows 2
- Secretary's Office 2
- PER Meeting 2
- Elks National Foundation Report ... 3
- School Supply Drive ... 3
- Food Drive 3
- The Dictionary Project 3
- Flag Day Wrap 4
- Picnic 5
- Oktoberfest 6
- Manager's Message ... 7
- Drink Specials 7
- Door Greeters 7
- Oktoberfest Flyer 8
- Banquets 9
- Ladies of the Elks Schedule 10
- Ladies Installation ... 10
- LOE Scholarships ... 10
- Calendar of Events ... 11
- Dinner Specials 11
- Entertainment 11
- Picnic Volunteer Form 12

Sizzlin' Summer: Golf, Horses, and a Picnic



A Message from the Exalted Ruler

By James Cusack, Exalted Ruler

July opens with our Lodge marching in the Des Plaines Fourth of July Parade. All members are invited to be part of the parade. The staging area is at Center and Oakton. The marcher should be in place by 9:00 am. The parade steps off at 10:00 am. We will have several vehicles and hope to carry a large American flag. Bring the kids or grandkids and instill the love of our Country in them. After the parade we will continue the celebration with hotdogs and drinks back at the Lodge. This will be our third patriotic event of the year. I am most grateful to all the members, their families, and community people that made both Memorial Day and Flag Day so special. Flag Day has received rave reviews from all in attendance. Our Flag Day chairman, Bill Brown, did a fabulous job.

We have many other events and activities coming up over the next few months. *cont. pg. 2*

Activities/Events

Horseshoe Casino Outing, July 17

\$25/person. Bus departs at 9:30 am. Sign up at Club.

Quarterly Club, Tuesday, July 29

\$15/members; \$20/non-members. Fabulous buffet!

Lodge Golf Outing, Thursday, July 31

Countryside Club (Prairies course) in Mundelein. \$75/golfer incl. 18 holes, cart, dinner, prizes and more!

Tony Ocean Show, Friday, August 1

\$15/person incl. hors d'oeuvres and show. Cash bar.

Eddie Cash Dinner Show, Sat. Aug. 9

\$25/person incl. dinner and show. Cash bar.

Lodge Picnic, Sunday, August 10

\$3/person includes burgers, brats, dogs, soda and beer. Raffle prizes Weber grill, Cubs lithographs, and more!



4th of July Parade

Parade kicks off Friday morning at 10 am. Marchers should be in place by 9 am.

Lodge is open after the parade from 11:30 to 3:30 pm.

Hotdogs and brats will be available.

Des Plaines Elks Annual Lodge Golf Outing

Thursday, July 31

Prairie Course at Countryside Golf Club in Mundelein, Illinois

\$75 per Golfer includes 18-holes of golf with cart, 3 golf balls, beer or soda and hotdog or brat on the turn, dinner at the Elks Club. Tee times from 8 am to 10:30 am. Sign up at the Main Bar with payment in full.



Day at the Races

Thursday, August 14 at Arlington Park



\$28/person incl. reserved box seating and dinner at the Club. Dinner choices are New York Strip Steak or Tilapia. One cocktail is included with dinner.



Lodge Officers 2008-2009

Exalted Ruler James Cusack
 Leading Knight Dolores Dean
 Loyal Knight Lee Burr Jr., PER
 Lecturing Knight Lawrence Kochan
 Secretary Donald Bahr, PER
 Treasurer Dale Multerer, PDDGER
 Tiler G. Bill Brown
 Esquire Don Knapp, PER
 Inner Guard Anthony Berardi
 Chaplain Richard Eirich, PDDGER
 Organist James Boyd

Trustees 2008-2009

Chairman Richard Lange
 4th-year George De La Mar
 3rd-year Gerald Smith, PER
 2nd-year Frank Hoef, PER
 1st-year Ronald Zuraski, PER

Board of Directors 2008-09

Chairman Lee Burr Jr., PER
 Vice-Chairman Dudley Parenteau, PER
 Secretary Lawrence Kochan
 Treasurer William Ritchie
 Director Anthony Berardi
 Director George Brown
 Director Gerald Snarski

Des Plaines Elks Club

Club Manager Randy Menzies
 E-mailRMenzies@desplaineselksclub.com

Elks Tooth 2008-2009

Editor Jeff Basko
 Home Phone 847 541-0556
 Fax 847 541-0885
 E-mail editor@elkstooth.com

Copy deadline for Sept is August 15

Lodge Phone: 847 824-1526

"Elks Tooth"

An Official Publication of the
 Benevolent and Protective
 Order of Elks,
 Des Plaines Elks Lodge #1526
 Published at:
 495 Lee Street
 Des Plaines, IL 60016
 Published monthly, with one
 combined issue for July/August

July-Aug. Meetings

Des Plaines Lodge Meetings

Tues July 01 NO MEETING
 Tues July 08 Trustee Mtg. 7:00 pm
 Tues July 15 Lodge Mtg. 7:30 pm
 Tues July 22 Directors Mtg. 7:00 pm
 Tues July 29 Quarterly Club 6:00 pm

Tues Aug 05 NO MEETING
 Sat Aug 09 Indoctrination 4:00 pm
 Tues Aug 12 Trustee Mtg. 7:00 pm
 Tues Aug 19 Lodge Meeting 7:00 pm
 Initiation
 Tues Aug 26 Directors Mtg. 7:00 pm

North District Meetings

Sun Aug 10 Woodstock #1043 at 1 pm
 District Deputy Clinic
 Sun Sept 07 Des Plaines #1526 at 1 pm



Secretary's Office

By Lodge Secretary,
 Donald Bahr, PER

Office Hours:
 Tues-Fri 10 am - 12 pm
 847-824-1526

On June 1, the Secretary's Office mailed approximately 180 delinquent notices to members of the Des Plaines lodge who were over 60 days past due on their 2008-09 membership dues. As of June 18, this number has dropped to 121 either by receipt of delinquent dues or by the members decision to be dropped from our roles for a variety of reasons. To those members who have not yet responded, please inform this office of your intentions.

We have only one lodge meeting in July (15th) and August (19th), and we have 18 candidates in waiting to become members. Indoctrination is scheduled for Saturday, August 9, with Initiation following at the August 19 meeting. Candidates in waiting will receive a "reminder" letter prior to the indoctrination date and the initiation date. Sponsors, please make sure your candidate attends both.

I was pleased as both a Veteran and an Elk to have witnessed an excellent presentation of our Flag Day program on Saturday, June 14. I believe the members were pleased to see the American flag honored as it should be on this day and every day. Thanks are due to many, but I will single out the Flag Day Committee Chairman, Bill Brown. You got it right Bill!

Lodge of Sorrows

*"The clock of their day has stopped
 and across its dial, motionless shadows
 mark the hour of eleven. With us,
 the golden hour of recollection."*

Gaston Freeman

Birth: 07/24/1922
 Initiated: 10/05/1953
 Death: 06/09/2008

W.W. Kaufman

Birth: 11/09/1923
 Initiated: 02/04/1947
 Death: 06/11/2008

*Arrangements for our Lodge of Sorrows
 Ritual for our deceased Members must
 be initiated by the Member's family.
 Contact the Lodge at 847-824-1526.*

PER Meeting

By PER Tom Bantz, PER Assn. Sec.

All Past Exalted Rulers, regardless of Lodge served, who are members in good standing at Des Plaines Elks Lodge #1526, are invited to attend the next PER Association meeting on Thursday, July 17.

Dinner is at 6 pm, followed by the meeting at 7 pm. The dress code is casual; you are encouraged to wear your red Elks polo shirt. Please plan to attend.

ER Article

cont. from pg. 1

They include our Lodge Picnic, a Tony Ocean concert and Oktoberfest. Please come out and support these and all our functions. Check the lobby and other articles for dates and times. Some events may require reservations or tickets.

I will attend the Grand Lodge Convention from July 6-10, and I'm very excited to be representing our Lodge at the convention. At the session we will install our new Grand Exalted Ruler and his District Deputies. It should be exciting and interesting.

Please do not forget about our charities. All our programs are going well, but we could improve. If your not sure about a program, please ask a Lodge officer or chairman. Stop by the Lodge and see who is there. We have been having some great fun lately and hope you will join us.

Www.ElksTooth.Com

Elks National Foundation Report

By Lee Burr Jr, PER, Des Plaines Elks National Foundation Chairman

When you give to the *Elks National Foundation*, you're doing more than funding the *Elks National Drug Awareness* and *Hoop Shoot* programs. You're doing more than supporting the Community Investment Programs and providing Emergency Educational Grants to the children of deceased or totally disabled Elks. You're doing more than maintaining the *Elks Veterans Memorial*.

You're doing all that, but most of all you're supporting Elkdom in Illinois.

During the 2007-08 Lodge year, the Elks of Illinois donated \$282,521.80 to the Elks National Foundation. For the 2008-09 Lodge year, the Foundation will give back the following to Illinois:

State Charities Grant	\$155,120.00
Special Projects Grants	94,570.00
Bonus Grants	44,860.00
Most Valuable Student	88,000.00
Legacy Awards	36,000.00
National Vets Srv. Comm.	19,440.00
Grand Total	\$437,990.00

That is a return to the State of \$1.55 for every dollar the Foundation received from Illinois in 2007-08.

I am happy to report that during the first two months of this Lodge year, our Lodge has donated \$3,621.00, our per-capita is \$2.038 based on 1776 members. So far, in June, I have mailed in \$995.00 and have another \$340.00 ready to mail in, which will give us a per-capita of \$2.79.

I want to thank the members, widows and spouses that have donated this year. If you have not donated this year or have already paid off your pledges, I am asking for your help—would you please donate \$10? If everyone would do that it will put us way over the Grand Exalted Ruler and the State President goals for the year.

If you have any question about the Foundation or would like to donate please contact me at (630) 620-6058 or see me at the Lodge. If you have donated and need a Red Heart for your membership card, please contact me.

Let show the rest of the State that the Des Plaines Elks "Care and Share." ☼

The Dictionary Project

Frank J. Burr, PER, Youth Activities Chairman

During the 2006 – 2007 lodge year, the Des Plaines Lodge undertook the Dictionary Project. The Dictionary Project was founded in 1995 by Mrs. Mary

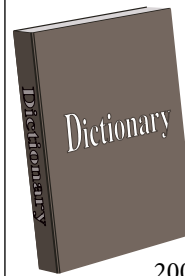

French of Charleston, S.C. The sole mission of this non-profit organization, which we, as Elks share, is to distribute dictionaries to as many third-graders as possible in the 50 United States. In the

2004–2005 Lodge year, the Benevolent and Protective Order of Elks became involved in this project.

The Dictionary Program is a wonderful community service project. It is also a wonderful literacy project; an opportunity to be involved in a hands-on project that does not require a great deal of time; is relatively inexpensive; is an opener of doors into the schools in our community; and is paving the way for other youth projects such as scholarships, essay contests, Hoop Shoot, Drug Awareness, etc.

With donations from our members and \$300 from the lodge, we ordered 456 dictionaries, which were given to 3rd graders in eight schools in the area. The dictionaries are not given to the schools but to the 3rd graders themselves to keep and use throughout their education. Each dictionary was labeled with Des Plaines Elks #1526 and a space for their names. Along with the dictionaries, each child received a Drug Awareness bookmark. The new bookmark features the Fantastic Four and Elroy the Elk.

Over the past month, I've received hundreds of hand made cards and photos from the 3rd grade classes thanking the Lodge for undertaking the Dictionary Project. I'm working on a display to showcase some of the cards and letters received. If you would like more information on the dictionary project you can go to www.elks.org or www.dictionaryproject.org. ☼

Ho-Do Pins and Illinois Elks Assn. Calendars

Ho-Do (Honorary Donor) pins are available at the Main Bar for \$10. Also, Illinois Elks Childrens Care Corp. Calendars are available for \$20 each and feature weekly drawings for cash prizes and more!

School Supply Drive

Frank J. Burr, PER, Youth Activities Chairman

It is never too early to think of our children's education. During the months of August and September, we will collect basic school supplies for local schools and organizations working with families who cannot afford school supplies. As last year, a container will be placed in the lobby of the Lodge, for your donations. Items we're looking for are: pens, erasers, pencils, color

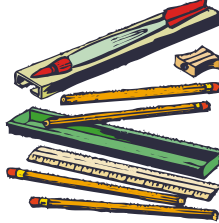

paper, writing paper, ringed note pads, rulers, crayons, and back packs. To make a monetary donation, send your check to the Lodge Secretary with "School Supply Program" in the memo space.

These items may seem basic to you and I, but to a child that desires to excel in school and life, they are major tools. If you have any questions, please see one of your Lodge officers. ☼

Food Drive

Frank J. Burr, PER, Youth Activities Chairman

Planning the next family cookout? Summertime is a great time for picnics and cookouts, but for some families, having enough food for a meal is a real problem.

We're asking for your help. Please bring your donations of non-perishable food to the lodge. The red baskets are available during regular lodge hours. To make a monetary donation, send your check to the Lodge Secretary with the "Red Basket" written in the memo space. Collections are given to the "Self-Help Closet & Pantry of Des Plaines." Let's make an extra effort this summer to show that Elks Care and Elks Share. ☼



For interesting news and humor, visit Carl Weldon's "Chatter" at www.desplaineselksclub.com

Des Plaines Elks Perform Flag Day Ceremony

On Saturday, June 14, Flag Day Chmn. G. Bill Brown MC'd a power-packed ceremony to more than 125 attendees. Pictured top left is member Ret. Lt. Col. USAF POW, Ewald Swanson (left) pictured with Flag Day Chmn. G. Bill Brown. The VFW Post 2992 presented "Swanee" with a U.S. Flag, which had

been flown over our Nation's Capitol last February. Mr. Swanson then presented the flag to US Marines, who installed our new flag. Pictured top right, David Seaholm gives an Ode to the Flag.

Photography by Jeff Basko



Left-middle: ER James Cusack performs the Ceremony. Left-bottom: The Chicago Police Dept. performed Color Guard duties with a wonderful marching presentment. Center-middle: Mstr. Sgt. Andrew Korous was the guest

speaker. He spoke of the Honor of the Flag both at home and abroad. Center-bottom: Sharon Miller recited the History of Our Flag. Right-middle:

Bud Vaughn addresses the meaning of the flag. Right-bottom: Echoing Taps was performed after Boy Scout Troop #6 marched the flags of the Armed Forces to their posts.



2008 LODGE PICNIC

Sunday, August 10, 2008

Lake Avenue Woods West

(Lions Woods is closed this year for repairs)

One block north of Euclid/Lake Avenue, entrance is on River Road.

Free Shuttles to Picnic from the Elks

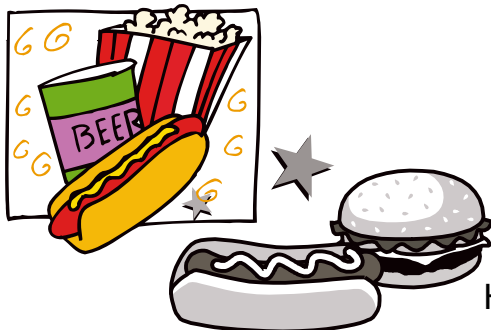

Parking at the picnic is reserved for handicapped and others with limited mobility.

Tickets \$3/person (must be purchased at the Lodge!)

Serving food from noon to 2 pm:

Hamburgers, hotdogs, and brats! Fresh corn-on-the-cob, ice-cream, and soda. Beer truck arrives at 11 am!

Bring your own chairs!

This year, we'll have plenty of fresh, cold drinking water and Gatorade®

The kids will love the Moonwalk!

And there will be plenty of GAMES and PRIZES for children: sack race, egg toss, bean-bag toss, and more!

You'll have a great time!

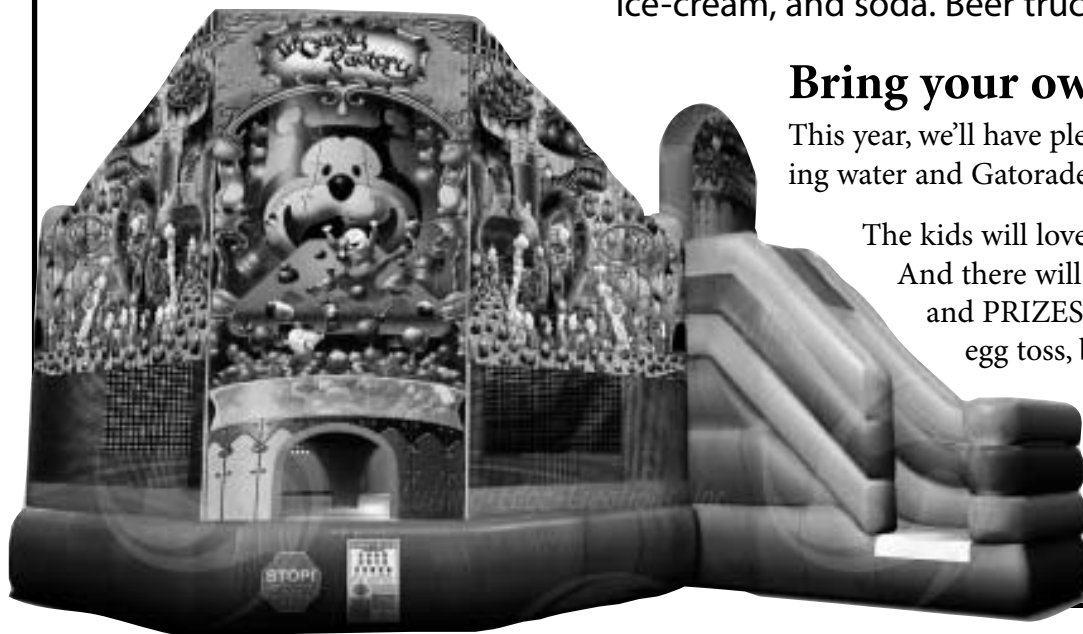

Oktoberfest 2008

Des Plaines Elks Club
Annual Fundraising Raffle
 When: Sunday, October 19, 2008
 Where: Des Plaines Elks Lodge #1526
 495 Lee Street
 Des Plaines, IL 60016

Buy your tickets before September 4th and you're eligible to win an Early-Bird Drawing for \$2,500.00

www.ElksTooth.Com

Support the Elks National Foundation

The ENF is the Life-Blood of the Order. It's through this foundation that all national support is provided. This includes national programs and local support. Now you can donate on-line at www.elks.org Website.

B I N G O

We Need BINGO Volunteers!

Members, Des Plaines Elks is in need of several volunteers to work BINGO at **least one Wednesday evening per month**. All volunteers start as Payout workers, but may advance to a Bingo Caller once familiar with the program.

BINGO directly benefits our lodge by generating funds necessary to help keep our dinner and drink prices reasonable. To sign up, call Larry Kochan at (847) 635-8993. Thank you.

Oktoberfest 2008

Ticket Price
\$50⁰⁰

Prizes Total
\$25,000

(Includes Two Early-Bird Prizes)

22 Prizes

Only 1,000 Tickets Sold

1 in 46 Chance to WIN a Prize!

VISA and MasterCard Accepted for Raffle Tickets



WHEN: Sunday, October 19, 2008 - Drawing at 8:00 P.M.
WHERE: Des Plaines Elks Lodge #1526
 495 Lee Street, Des Plaines, IL 60016
 Phone: (847) 824-1526

GRAND PRIZE: \$10,000

GRAND PRIZE: \$10,000	4TH & 5TH PRIZES: \$800 EA
2ND PRIZE: \$3,000	PRIZES 6-12: \$500 EA
3RD PRIZE: \$1,000	PRIZES 13-20: \$300 EA

PLUS, TWO EARLY-BIRD DRAWINGS!

THURSDAY, SEPT. 4, 2008	DRAWING AT 7 PM	PRIZE: \$2,500
THURSDAY, OCT. 2, 2008	DRAWING AT 7 PM	PRIZE: \$1,000

Grand Drawing: Sunday, October 19, 2008 at 8 PM
 Winner need not be present. Not tax deductible.

Sponsor the Elks Tooth!

Purchase a Business Card Ad for only \$140 for six issues.
 Contact the Editor at 847-541-0556

Century 21
McMullen Real Estate, Inc.
 CENTURION® Office, 1987-2005
 6400 N. Harlem Avenue
 Chicago, Illinois 60631
 Residence (847) 292-0006
 Cell (773) 718-8800
 Each office is Independently Owned and Operated

Polona (Polly) Filpi
 REALTOR®
 Lifetime Million Dollar Salesperson
 Office 2005
 Million Dollar Club
 Office 1987-05

10820

Lippers Carpet Cleaning
 Carpet & Upholstery
 Residential • Commercial • Auto
Dave Lipp
 Off-Duty Fireman (773) 244-9027

Frank's Home Repair
 Frank Witkus 847 894-0359

- Free Estimates
- Interior Painting
- Exterior Painting
- Plumbing
- Maintenance
- Electrical
- Honey-Do List
- Minor Remodeling
- Door and Window Replacement
- Free Fishing Tips

"I will repair what you have attempted"

Please Support our Sponsors

Play BINGO Every Wednesday!
Doors open at 4 pm.

As of Jan. 1, 2008
NO SMOKING
Anywhere in the Lodge

Sponsor the Elks Tooth for only \$140

Cabinets Bathrooms Kitchens
 Rec. Rooms Plumbing Ceramic
 Electrical Custom Tile

Jeff Lipman Construction, Inc.
Quality is our game!
Jeff Lipman
 (847) 657-8990 Whirlpool Tubs
 Cell (847) 208-8998 Custom Tops

Please Support our Sponsors

10849 **AHLBECK & COMPANY**
 CERTIFIED PUBLIC ACCOUNTANTS

Thomas H. Ahlbeck, CPA
 Dirk T. Ahlbeck, CPA
 Amy J. Sullivan, CPA

1665 ELK BOULEVARD TEL: 847/824-4000
 DES PLAINES, ILLINOIS FAX: 847/824-4012
 60016-4798

ELKS CLUB

847-824-1556
847-824-2036 fax
Randy@DesPlainesElksClub.com



Randy Menzies
Elks Club Manager

Manager's Message *by Randy Menzies, Club Manager*

This summer is hopping-busy with many events in which to have fun.

Friday, the 4th of July, we will be open from 11:30 to 3:30 after the parade. Brats and Hot dogs will be served from 11:30 to 1:30 so stop by.

Thursday, July 17, is our Horseshoe Casino outing. The bus departs the lodge at 9:30 a.m. with a lunch buffet included. Gambling is from 11:30 am to 3:30 pm with dinner back at the Lodge. \$25/person includes one cocktail with dinner. Stop in at the club to sign up (payment in full required at sign-up).

Tuesday, July 29, is the Quarterly Club. Members pay \$15.00 and non-members pay \$20. The elaborate Buffet starts at 6:00 pm. Bring a friend and make him a member.

Thursday, July 31, is our Lodge Golf Outing on the Prairie Course at Countryside Golf Club in Mundelein. Tee times from 8 to 10:30 am. \$75 per golfer includes: 18 holes of golf with cart, 3 balls, beer or pop, hotdogs or brats on the turn, and dinner buffet back at the lodge. Cocktails: 4 pm; dinner: 4:30 pm. Prizes for longest putt and closest to the pin. Door prizes included.

Friday night, August 1, Tony Ocean Show and Dancing. Hors d'oeuvres from 6 to 8 pm. Tony is very well known with a great voice. A must-see. Tickets are \$15.00 per person.

Saturday night, Aug 9, is the Eddy Cash Dinner Show. Cash bar and hors d'oeuvres start at 6 pm, with dinner at 7 pm. Menu: fresh fruit cup, spinach salad, Chicken

Wellington with rice pilaf, and a vegetable with a chocolate Sunday for desert. All for \$25.00 per person.

Sunday, August 10 is the annual Lodge Picnic, held this year at Lake Avenue Woods-West in Mt. Prospect. \$3 per person includes fresh corn, burgers, dogs, brats, soda, beer, and more. Enter the raffle and you could win Big. Food will be available from noon to 2 pm. Park at the lodge and take a free bus ride to the picnic. If you want to help out, call the picnic chmn, Jeff Basko at 847-541-0556.

Thursday, August 14, is Day at the Races at Arlington Park Race Track. \$28.00 per person includes reserved box seating, and dinner back at the Club. Dinner choices are New York Strip Steak or Tilapia. One cocktail is included with dinner.

Thursday, September 4, is the first Oktoberfest Early Bird drawing. You can win \$2500, so buy your ticket early. 🍀

Oktoberfest tickets are on sale!

The Oktoberfest Raffle is our largest annual fundraising event, providing upgrades and improvements to our facilities. We appreciate your support in the past and look forward to your support this year. Contact me if you wish to sell tickets. 🍀

Find Your Lucky Member Number!

If your member number appears in a sponsored ad or Club ad, stop by the Club and receive a \$10 gift certificate – good anytime at the Club!
Good Luck!

Drink Specials for July-August

- Tuesday:** Draft Beer Day \$1.25
- Wed:** Wine Spritzer 3.00
Mai Tai..... 4.00
- Thurs:** Tony Bahama Colada 4.00
- Friday:** Baileys Caramel Apple Martini
or Midnight Martini 4.00
- Sat:** Baileys Mint Chocolate Martini
or Sangria 4.00

Door Greeters

Volunteers or Rescheduling:
Contact Marie Reale (847) 476-8700
Hours: 5:30 – 7:30 PM

— JULY —

Friday

- 04 Closed
 - 11 Ann Barton
 - 18 Fred Gross
 - 25 Dan Fluett
- Saturday**
- 05 Margot Briars
 - 12 Amelia Faxel
 - 19 Casey Mironack
 - 26 Lori Rock

— AUGUST —

Friday

- 01 Amelia Faxel
- 08 Louis D'Attomio
- 15 Fred Gross
- 22 Louis D'Attomio
- 29 Dan Fluett

Saturday

- 02 Lori Rock
- 09 Jim Estey
- 16 Casey Mironack
- 23 Margot Briars
- 30 Kathe Zehr

Des Plaines Elks Club Annual Fundraising Raffle

Oktoberfest 2008

\$25,000 in Total Prizes — Grand Prize: \$10,000

Grand Drawing: Sunday, October 19, 2008 at 8 p.m.

Two Earlybird Prizes: \$2,000 and \$1,500

1st Earlybird Drawing: Sept. 4, 2008 for \$2,000 prize at 7 p.m.

2nd Earlybird Drawing: Oct. 2, 2008 for \$1,500 Prize at 7 p.m.

Dear Members and Friends,

Please **ACT NOW!** Take this opportunity to get your **2008 Oktoberfest Raffle Ticket**. Last year, our ticket sellers were nearly sold out *before the First Early Bird Drawing*.



Order Today.

We accept:

Cash

Check

Visa

MasterCard

Please Hurry, Act Today! – Donation: \$50

Prize Breakdown: 1st Prize: \$10,000; 2nd Prize: \$3,000; 3rd Prize: \$1,000;
4th & 5th Prizes: \$800 each; 6th thru 12th Prizes: \$500 each; 13th thru 20th Prizes: \$300 each.

Plus: Two Early Bird Prizes: 1 @ \$2,000 and 1 @ \$1,500!

22 Prizes, Only 1,000 Tickets Sold = 46 to 1 Odds!

Top Seller Prize: Every time you sell five (5) tickets, an entry blank for a special raffle will be generated on your behalf. The “Top Seller” drawing will be on Oktoberfest Sunday.

Prizes are: 1st - \$300; 2nd - \$200; 3rd - \$100. If you would like to join the Sales Committee, please contact Randy Menzies at the Lodge at 847 824-1556.

Note to Lodge Members: If you sell five (5) tickets by the **FIRST** Early-Bird Drawing on Sept. 4, 2008, you will receive a \$10 Gift Certificate for use in the Club. (E.G.,if you sell 20 tickets, you will receive a \$40 gift certificate!) Remember, to qualify, tickets must be sold **before the FIRST Early-Bird Drawing!**

Thank you from Randy Menzies, Club Manager and the 2008–2009 Board of Directors.

Order Form

To: 2008 Oktoberfest Raffle Committee

Date: _____

I wish to purchase _____ tickets at \$50.00 each = \$ _____ Total

Please find my check enclosed for \$ _____

Credit Card No. _____ Exp. Date _____



Please Consign to me _____ Tickets Signature _____

Name _____

Address _____

City _____ State _____ Zip _____ Phone _____

Des Plaines Elks Club Banquets

The Des Plaines Elks Club prides itself on a tradition of outstanding value. Our menu selection includes a variety of dishes, each carefully prepared. We use the finest meats, poultry, vegetables and grains from the foremost purveyors in the business.

Banquet Facilities are available seven days a week with accommodations from 25 to 250 people. An excellent choice for Wedding Receptions, Birthday Parties, Anniversary Celebrations and Funeral Luncheons.

Our Package Menu includes a Four-Hour Bar Service (*we serve better brands*) with Complimentary Champagne or Wine served with Dinner (*unlimited*)



Entrees Include: Prime Rib, Filet Mignon, Ribeye Steak, New York Strip, Butt Steak, London Broil, Roast Sirloin of Beef, Roast Beef, Chicken, Orange Roughy, Baked Scrod, Lake Superior Whitefish, Roast Turkey and Family Style Dinners

Side Fare: Choice of Appetizers, Vegetable, Potato, Salad and Dessert

Extras: Hors d'oeuvres

From \$31.00 to \$40.00 per plate. Prices include complete dinner, four-hour bar and gratuities.

Main Banquet Facility (Downstairs)

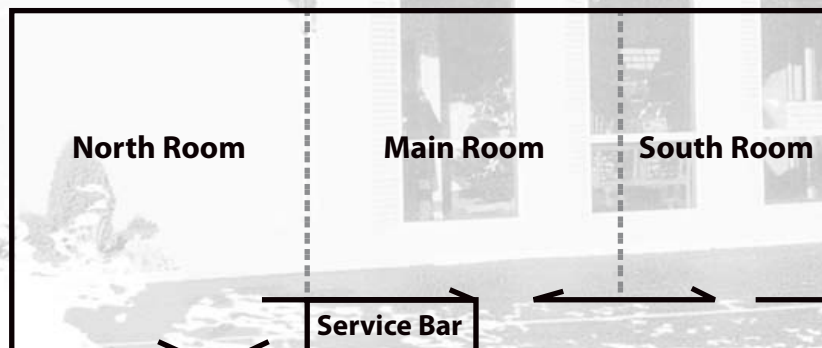

Upstairs Banquet Facilities:

PER Room: 16-1/2 x 18 feet
Accommodates 15 to 30 people

Fireside Lounge: 19-1/2 x 30-1/2 feet
Accommodates 24 to 50 people

Main Banquet Facility (Downstairs) is Handicapped Accessible with wheelchair lifts in Lobby and Foyer.

To Book Your Special Occasion, contact Club Manager, Randy Menzies at 847-824-1526

North Room: 39 x 44 feet
Accommodates 25 to 100 people

Main Room: 38 x 39 feet
Accommodates 25 to 100 people

South Room: 19 x 44 feet
Accommodates 15 to 50 people

Open Room: 100 x 44 feet
Accommodates up to 250 people

Des Plaines Ladies of the Elks

July-Aug Schedule

Submitted by Dolores (Dee) Dean,
Publicity Chairman

Meetings:

There are no regular meetings during July and August. A Happy and Safe Summer to Everyone!

Dates to Remember:

Please remember to bring non-perishable items to **fill the red buckets** in the lodge lobby. Please help others in our community who are in need.

Sunday, August 10 is the lodge picnic. Jeff Basko is the Chairman and he needs volunteers to serve food, sell raffle tickets, cooking, set up games and many other areas where help is needed. Jeff can be reached at (847) 541-0556 or fill out the form in the Elks Tooth and return it to Jeff ASAP.

This year, the picnic is at Lake Ave Woods West in Mt. Prospect, Illinois. **Tickets are \$3 per person and you must purchase tickets at the lodge** before hand. There is only parking at the picnic for handicapped and others with limited mobility. Bring your own lawn chairs. See elsewhere in this newsletter for more details.

Saturday, August 16, is our Veterans Picnic at the VA North Chicago. If you have signed up to work this picnic please be at the lodge on picnic day by 9:00 AM sharp as we will caravan up to the picnic. If you have a question call Dee Dean (847) 590-8273.

In August the lodge will have a **school supply drive**. We will need pens, pencils erasers, colored paper, writing paper, ringed notebooks, rulers, crayons and backpacks. Monetary donations are also accepted and can be sent to the lodge Secretary Don Bahr. Please mark School Supplies in the memo area of your check.

Oktoberfest raffle tickets are on sale at \$50 each. For tickets, see Manager Randy Menzies, bartenders Denise, Angelo, Dottie in the dining room, or any Club Director. If you can sell a few tickets (five?) to family and friends, ask Mgr. Randy to consign them to you. Everyone wants to win ten large! ☺

Ladies of the Elks Installation of Officers

On Saturday, June 7, 2008, the Ladies of the Elks installed their new officers for the 2008-2009 fraternal year. This year, Past President Jan Stein has once again taken the helm as President.



2008-2009 Officers — seated L to R — Treasurer, Sue Rustman; President, Jan Stein; Vice President, Mary Brown; — standing L to R — Chaplain, Isabella Burwell; Antler Guard, Ingried Wojewoda; Corresponding Secretary, Dolores Tom-scheck; Recording Secretary, Doris DeFranceschi; Inner Guard, Carlota Kozak. Bible Guard, Sharon Hoff (far right) was installed at the general meeting on Tuesday, June 12.

Ladies of the Elks Award Annual Scholarships

Des Plaines Ladies of the Elks work very hard throughout the year to raise monies for charitable causes. Their scholarship program is the crème de le' crème of all their programs. Each recipient was awarded \$1,000.00!



2008 Scholarship Recipients — Seated L to R — Exalted Ruler James Cusack; President Addie Rokicki; Scholarship Donor Marguerite Kempsteon; Scholarship Chairwoman Betty Panella and Joy Graser. — Standing L to R — Stephanie Nekano, Lauren Checcher (Maine West HS), Bill Vogg (Main South HS), Amanda Zito, Nicole Gordon (Maine West HS).

Elks Club Events for July-August

SUNDAY	MONDAY	TUESDAY	WEDNESDAY	THURSDAY	FRIDAY	SATURDAY
Complimentary Hors d'oeuvres 4 PM to 6 PM		1 10 Oz. Rib Eye 8.95 Danish Lobster 14.95 No Meeting	2 8 Oz. Burger 6.95 Fried Chicken 7.95 Bingo 7 PM	3 Filet of Sole 10.95 Prime Rib 11.95 BBQ Pork Ribs Full Slab 12.95	4 Club Open 11:30-3:30 Brats After Parade	5 8 Oz. Lobster 17.95 Music & Dancing Chuck Masny
6 <i>Club Closed</i>	7 <i>Club Closed</i>	8 10 oz. Butt Steak 9.95 Danish Lobster 14.95 Trustee Meeting 7 PM	9 8 Oz. Burger 6.95 Fried Chicken 7.95 Bingo 7 PM	10 Saute Brook Trout Almondine 9.95 Prime Rib 11.95 BBQ Pork Ribs Full Slab 12.95	11 Fish Fry Ocean Perch 7.95 Broiled Scrod 9.95 Arctic Perch 9.95 Chuck Masny	12 Beef Wellington 14.95 Music & Dancing Chuck Masny
13 <i>Club Closed</i>	14 <i>Club Closed</i>	15 New York Strip Steak 12 Oz 9.95 Danish Lobster 14.95 Meeting 7:30 PM	16 8 Oz. Burger 6.95 Fried Chicken 7.95 Bingo 7 PM	17 Horseshoe Casino Bay Scallops DeJonge 11.95 Prime Rib 11.95 BBQ Pork Ribs Full Slab 12.95	18 Fish Fry Ocean Perch 7.95 Broiled Scrod 9.95 Arctic Perch 9.95 Music & Dancing Jim Boyd	19 Jumbo Coconut Shrimp 15.95 w Music & Dancing Jim Boyd
20 <i>Club Closed</i>	21 <i>Club Closed</i>	22 T-Bone Steak 18 Oz, 15.95 Danish Lobster 14.95 Director Meeting 7 PM	23 8 Oz. Burger 6.95 Fried Chicken 7.95 Bingo 7 PM	24 Smoked Butt & Cabbage 8.95 Prime Rib 11.95 BBQ Pork Ribs Full Slab 12.95	25 Fish Fry Ocean Perch 7.95 Broiled Scrod 9.95 Arctic Perch 9.95 Music & Dancing Jim Boyd	26 Lobster Tail 8 Oz. 17.95 Music & Dancing Jim Boyd
27 <i>Club Closed</i>	28 <i>Club Closed</i>	29 New Zealand Lamb Chops 13.95 Danish Lobster 14.95 Quarterly Club 6 PM	30 8 Oz. Burger 6.95 Fried Chicken 7.95 Bingo 7 PM	31 Lodge Golf Countryside Grecian Whitefish Prime Rib 11.95 BBQ Pork Ribs Full Slab 12.95	1 Tony Ocean Show Fish Fry Ocean Perch 7.95 Arctic Perch 9.95 Broiled Scrod 9.95 Ed Knaack Duo	2 Chateaubriand Plate Style Music & Dancing Ed Knaack Duo
3 <i>Club Closed</i>	4 <i>Club Closed</i>	5 Rib eye Steak 10 oz. 10.95 Danish Lobster 14.95 No Meeting	6 8 oz. Burger 6.95 All You Can Eat Fried Chicken 7.95 Bingo 7 PM	7 Brook Trout Almondine 9.95 Prime Rib 11.95 BBQ Pork Ribs Full Slab 12.95	8 Fish Fry Ocean Perch 7.95 Broiled Scrod 9.95 Arctic Perch 9.95 Music & Dancing Jim Boyd	9 Eddie Cash Show 8 Oz. Lobster 17.95 Music & Dancing Jim Boyd
10 <i>Club Closed</i>	11 <i>Club Closed</i>	12 Butt Steak 10 Oz. 10.95 Danish Lobster 14.95 Trustee Meeting 7:PM	13 8 Oz. Burger 6.95 All You Can Eat Fried Chicken 7.95 Bingo 7: PM	14 Arlington Race Track Filet of Sole 9.95 Prime Rib 11.95 BBQ Pork Ribs Full Slab 12.95	15 Fish Fry Ocean Perch 7.95 Arctic Perch 9.95 Broiled Scrod 9.95 Music & Dancing Jim Boyd	16 One Pound King Crab legs 16.95 Music & Dancing Jim Boyd
17 <i>Club Closed</i>	18 <i>Club Closed</i>	19 Apricot Pork Roast & Dressing 8.95 Danish Lobster 14.95 Meeting 7:30 PM	20 8 Oz. Burger 6.95 Fried Chicken All You Can Eat 7.95 Bingo 7 PM	21 Rosemary Salmon 10.95 Prime Rib 11.95 BBQ Pork Ribs Full Slab 12.95	22 Fish Fry Ocean Perch 7.95 Arctic Perch 9.95 Broiled Scrod 9.95 Music & Dancing Larry Hulina	23 Jumbo Coconut Shrimp 14.95 Music & Dancing Larry Hulina
24 <i>Club Closed</i>	25 <i>Club Closed</i>	26 18 Oz. T-Bone 15.95 Danish Lobster 14.95 Director's Meeting 7:00PM	27 8 Oz. Burger 6.95 Fried Chicken All You Can Eat 7.95 Bingo 7 PM	28 Bay Scallops Au Gratin Prime Rib 11.95 BBQ Pork Ribs Full Slab 12.95	29 Fish Fry Ocean Perch 7.95 Arctic Perch 9.95 Broiled Scrod 9.95 Music & Dancing Chuck Masney	30 Beef Wellington 14.95 Music & Dancing Chuck Masney
31 <i>Club Closed</i>	THE DES PLAINES ELKS CLUB RESERVES THE RIGHT TO WITHDRAW OFFERS DUE TO TYPOGRAPHIC ERRORS.					
Complimentary Hors d'oeuvres Served 4–6 PM Tuesday–Saturday at the Main Bar						
Club open Sundays for Parties and Banquets. Call Club Mgr. Randy Menzies for details at 847-824-1556.						

Lovejoy

Home Care Services
Providing Quality Care Givers

Live-in and Hourly Service Available Contact us at (773) 202-2615

5546  **That's A Tuffy!**

Robert A. Popjoy, Jr.
10% OFF
any repair with this coupon

www.tuffy.com Tel: (847) 679-9003
4401 W. Touhy Ave. Fax: (847) 679-0948
Lincolnwood, IL lincolnwoodtuffy@comcast.net

Sponsor the Elks Tooth! Business card ads are only \$140 for six issues. Contact the Editor, Jeff Basko at 847-541-0556

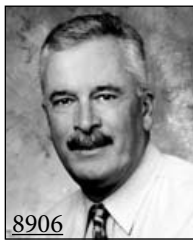

330 E. Northwest Highway, Mt. Prospect, IL 60056
Office: (847) 259-0202 www.IllinoisProperty.com
E-mail: James.Grady@comcast.net

RE/MAX®
Suburban
Jim Grady, GRI
Broker/Manager

Whether you're buying or selling a home, choose RE/MAX Suburban for the professional edge.



DES PLAINES—GREAT FAMILY HOME! Classic center entry Georgian features lovely formal Liv Rm w/gas log fireplace; sep DR; pantry off eat-in Kit; wonderful 1st flr Fam Rm overlooking backyard. Lots of room in full bsmt w/outside entry. Walk to Cumberland train station! **\$319,900** ▶



DES PLAINES—CLOSE TO EVERYTHING! Charming, classic 2BR Bungalow with custom red brick fireplace in LR, sep DR, fabulous Kitchen, large MBR. Beautiful hardwood flrs t/o! Dry basement recently refinished w/bath & office! Lots of storage! Delightful backyard. **\$299,000** ▼



DES PLAINES—UNBEATABLE DEAL! **\$124,000** ▲
Walk to train from this 1st floor condo unit with a garage! One bedrm, new windows, freshly painted, storage in basement. Next to a park, close to town & shopping! Assoc fee includes heat & water!

Des Plaines Elks Lodge Annual

PICNIC 2008

Picnic Volunteer Form

Date: Sunday, August 10, 2008

Where: Lake Avenue Woods West, Mount Prospect, IL

Members: Please consider volunteering an hour or two of your time to help us make this year's Lodge Picnic a success.

Volunteer time slots available from 9 am – 5 pm. Even if you've volunteered before, PLEASE let us know you're coming and what service you prefer. Check below what you wish to work:

- Setup/Corn Prep Entranceway
- Cooking (*bring apron*) Serving Beer / Soda
- Serving Food Games
- Sell Raffle Tickets at Club in Lobby
- Other _____

Name _____

Phone _____

Time Available _____

Please return this form to the lodge by July 20, 2008, or FAX to 847-541-0885. Questions? Phone the Picnic Chmn, Jeff Basko at (847) 541-0556.

Des Plaines Elks Lodge No. 1526
495 Lee Street
Des Plaines, IL 60016

POSTMAN: TIME-SENSITIVE DATES. PLEASE DELIVER AT ONCE.

Non-Profit
Organization
US Postage
PAID
Permit No. 7
Des Plaines, IL