

# ElkStooth



October, 2011  
www.elkstooth.com

All-American Lodge  
2008-2009 State

**INSIDE:**

## DDGER Homecoming Nov. 1 at Des Plaines Lodge

- Meeting Schedule ... 2
- Secretary's Office .... 2
- Deceased ..... 2
- Summary of Resolutions ..... 2
- Notice of Real Estate Proposal ..... 3
- Reaction to Real Estate Proposal ..... 3
- 2011 Elks Hoop Shoot ..... 3
- New Members ..... 4
- D.P. Elks Veterans Club Mtg. .... 4
- Door Greeters ..... 4
- Oktoberfest Raffle ... 5
- 50+ Honorees ..... 5
- Warm Hugs ..... 5
- Holiday of Hope ..... 5
- Oktoberfest Flyer .... 6
- Manager's Message .. 7
- Saturday Night Specials ..... 7
- Drink Specials ..... 7
- DJ Tony ..... 8
- Banquet Menu ..... 9
- Breakfast with Santa Claus ..... 10
- Funeral Menu ..... 10
- Play Bingo ..... 10
- Be Part of... ..... 10
- Calendar of Events ... 11



### From the Exalted Ruler

By Daniel Burns

October is here already and with it comes the Lodges Oktoberfest celebration on Saturday, October 29. Tickets are still available for the \$10,000 grand prize. This is an all-day celebration with a special menu. The drawing takes place at 9:00 pm. Please participate; this is the largest Club fundraiser of the year and the proceeds go to make some needed improvements. Bring your friends and family and introduce them to Elkdom and all the programs that we offer.

**Our own Lodge Sec., Don Bahr, is District Deputy Grand Exalted Ruler this year** for the North District. Don's homecoming with his staff will be on November

1st when they will conduct our Lodges' annual inspection. This is a great time for members to attend the meeting and welcome the visitors from the North District as well as the new members that will be initiated that night. We have been doing a great job of bringing in new members but we need to do a better job of keeping them in our Lodge. Please do your best to introduce yourself and make people feel welcome when you see them. Call members that you have not seen at the Lodge for a while and encourage them to come by and have some fun. There's always plenty of activities for everyone to enjoy.

Thanks to Youth Activities Chair, Lori Lichter, and the people who helped with this year's dictionary program.

*cont. page 5*

## Activities & Events

- NFL® Sunday Afternoon Football**  
See events calendar for featured games. Bucket of Miller (5 bottles) for \$12.50 / draft pints only \$2.
- All-Day Drink Specials Tuesday-Saturday**  
Enjoy a different beverage treat at a special price! See drink and beer specials inside.
- Monday Night Football - Bears at Lions**  
 **Open Oct. 10 at 6 pm, kickoff 7:30 pm. Good matchup!**
- Glenview Fall Golf Outing, Thur, Oct. 13**  
\$75/golfer incl. 18 holes, cart, lunch, dinner. Main bar.
- Oktoberfest Celebration and Drawing**  
**Saturday, October 29.** See flyer inside. Drawing at 9 pm
- Breakfast With Santa Reservations**  
Des Plaines Elks Children's Christmas Party. Reservation form and details inside.
- Des Plaines Elks Wednesday Night Bingo**  
Doors open at 4 pm. Earlybird game starts at 6:45 pm. Free coffee & soda, reasonably priced snacks. **Chicken dinner special** at bingo - please order before 5:30 pm.

**Turkey Shoot All-Day / Night**  
**Thursday, Nov. 17, start 11 am**  
*Complimentary turkey sandwiches mid-afternoon & late evening!*

**Hey Pilgrim! We're raffling turkeys, booze, cash, and more!**



**Fireside "No-Cover" Entertainment**

Friday Nights		Saturday Nights	
10/07	DJ Tony Spumoni	10/01	Ed Knaak
10/14	Jimmy Boyd	10/08	LaVerne & Paul
10/21	DJ 'Hey Tony'	10/15	Vince Micari Jr.
10/28	DJ Paul Adams	10/22	John Matt Trio
11/04	DJ Tony Macaroni	10/29	Chuck Masny
		11/05	Ed Knaak

**District Deputy Homecoming Meeting**  
Tuesday, November 1, 2011  
Des Plaines Lodge member and this year's North District DD, Don Bahr and his staff will be present for the Initiation meeting. **Members-only admitted after 5 pm.**



**Lodge Phone: (847) 824-1526**

### Lodge Officers 2011–2012

Exalted Ruler..... Daniel Burns  
Leading Knight ..... August Schwiesow  
Loyal Knight..... Michael Butler  
Lecturing Knight.....Patrick Manning  
Secretary ..... Donald Bahr, PER  
Treasurer ..... Dale Multerer, PDDGER  
Tiler ..... Danny Tetzlaff  
Esquire..... Donald Knapp, PER  
Inner Guard ..... Jonathan Robb  
Chaplain ..... Richard Eirich, PDDGER  
Organist ..... Bernard Domenz

### Lodge Trustees 2011–2012

Chairman..... Frank Hoeft, PER  
4-year .....Ronald Zuraski, PER  
3-year .....James Cusack, PER  
2-year .....Dolores Dean, PER  
1-year.....Thomas Bantz, PER

### Club Directors 2011–2012

Chairman..... Gerald Smith, PER  
Vice-Chmn. ....Dean Stewart, PER  
Secretary ..... Patrick Manning  
Director ..... Dudley Parenteau, PER  
Director..... Michael Butler  
Director ..... August Schwiesow  
Director ..... William Ritchie

### Des Plaines Elks Club

Club Manager ..... Randy Menzies  
E-mail ....RMenzies@desplaineselksclub.com

### Elks Tooth 2011–2012

Editor ..... Jeff Basko  
Home Phone..... 847 541-0556  
E-mail ..... editor@elkstooth.com

**Copy deadline for November is Oct. 15**

## "Elks Tooth"

An Official Publication of the  
Benevolent and Protective  
Order of Elks,  
Des Plaines Elks Lodge #1526  
Published at:  
495 Lee Street  
Des Plaines, IL 60016  
Published monthly, with one  
combined issue for July/August

## October Meetings

### Des Plaines Lodge Meetings

Tues Oct 04 Initiation Meeting 7:30 pm  
Tues Oct 11 Trustees Meeting 7:00 pm  
Tues Oct 18 Lodge Meeting 7:30 pm  
Tues Oct 25 Directors Meeting 7:30 pm

**Tues Nov 01 District Deputy Night,  
Homecoming of  
the North District, IL,  
DDGER, Donald Bahr**

Members: Please attend Nov. 1 and show  
your support for our own — Don Bahr.



### Secretary's Office

By Lodge Secretary,  
Donald Bahr  
District Deputy Grand Exalted  
Ruler, North District, Illinois  
Office Hours: Tues–Thur,  
10:30 am– 1 pm

Nine new members were initiated on Tuesday, September 6, 2011. This brings our total new members for this lodge year to 43, currently totaling 1,450 members. Last year at this time we had initiated over 60 new members. Membership is a constant chore that we are all obligated to address if our lodge is to prosper and grow. I have always encouraged each member to sponsor one new member each year. You do the math.

If our lodge could accomplish this just one year, think of the wonderful challenges it would create. The bar area, the restaurant, our charities, how would we manage such an increase in membership. Yes, I know, secretary what are you thinking, well it's nice to dream once in a while; it's good for you. It would be even better if this dream could actually come true.

*I have always encouraged each  
member to sponsor one new  
member each year.*

I am requesting your help again this year, as many of our members will soon be traveling to their wintering states. This means address changes must be submitted, preferably in writing, to the lodge secretary to update and ensure that our addresses and telephone numbers are in sync.

Please be considerate of lodge mailings, as your 2012-13 membership dues will be mailed in February to the address the lodge has in your account profile. It is the member's responsibility to inform the secretary's office of your desired mail destination. Failure always leads to "I never received my

## Lodge of Sorrows

*"The clock of their day has stopped  
and across its dial, motionless shadows  
mark the hour of eleven. With us,  
the golden hour of recollection."*

### Edwards, Mathew

Born: 21-Sep-1921  
Initiated: 20-Mar-1990  
Death: 16-Aug-2011

### Froehlich, Faye C.

Born: 03-Jun-1934  
Initiated: 18-Sep-2001  
Death: 24-Aug-2011

### Mallin, Edmund P.

Born: 17-May-1917  
Initiated: 01-Oct-1962  
Death: 24-Aug-2011

### Wolz, Anton

Born: 15-Apr-1929  
Initiated: 18-May-2010  
Death: 24-Aug-2011

*Arrangements for our Lodge of Sorrows  
Ritual for our deceased Members must  
be initiated by the Member's family.  
Contact the Lodge at (847) 824-1526.*

dues notice" when your name is published on the delinquent dues list. Do not rely on the post office to forward your mail and do not send your payment to the Grand Lodge; send your dues to your Lodge Secretary. Your help and understanding is always appreciated.

## Summary of Resolutions Vote

*Submitted by Don Bahr, DDGER, Lodge Sec.*

Please note: The official results will be published in the Proceedings as there were some amendments made on the floor.

1. To eliminate the requirement that Lodge officers memorize the Ritual.

Yes: 1836 No: 1363

2. To allow the use of alternate Rituals approved by Grand Lodge.

Yes: 1894 No: 1302

3. To allow the posting of candidates' names prior to voting. Yes: 2702 No: 490

4. To transfer the duties of the Grand Treasurer to the Grand Secretary.

Yes: 2503 No: 691

5. To allow a reward for recruiting and retaining members. Yes: 2348 No: 847

*continued page 4*

## Notice of Real Estate Proposal

### Proposed Sale of a Parcel of the Lodge Parking Lot

By Frank Hoeft, PER, Chmn. Board of Trustees

The lodge has received an unsolicited proposal from Troy Development to purchase 11,600 square feet of our parking lot. The portion of the lot they are interested in can be seen on the drawing accompanying this notice (right).

The purchase is contingent upon the City of Des Plaines agreement to sell the city owned property, which we currently lease from the City of Des Plaines. The purchase offer is \$350,000 plus an additional \$75,000 to be used to repave our lot.

Some key components are: (1) The number of parking spaces will be reduced from 123 to 98. (2) The Developer will provide a shared parking arrangement, making additional spaces available. (3) The proposed development is for a financial institution, so its hours of operation would not necessarily conflict with the parking requirements of our membership. (4) 98 parking spaces can accommodate most lodge functions.

This offer is significantly higher than the per square foot price paid by the City of Des Plaines for a portion of our property last year.

A vote on this matter will be made at the lodge meeting, which begins at 7:30 pm on October 18, 2011. A copy of the propos-

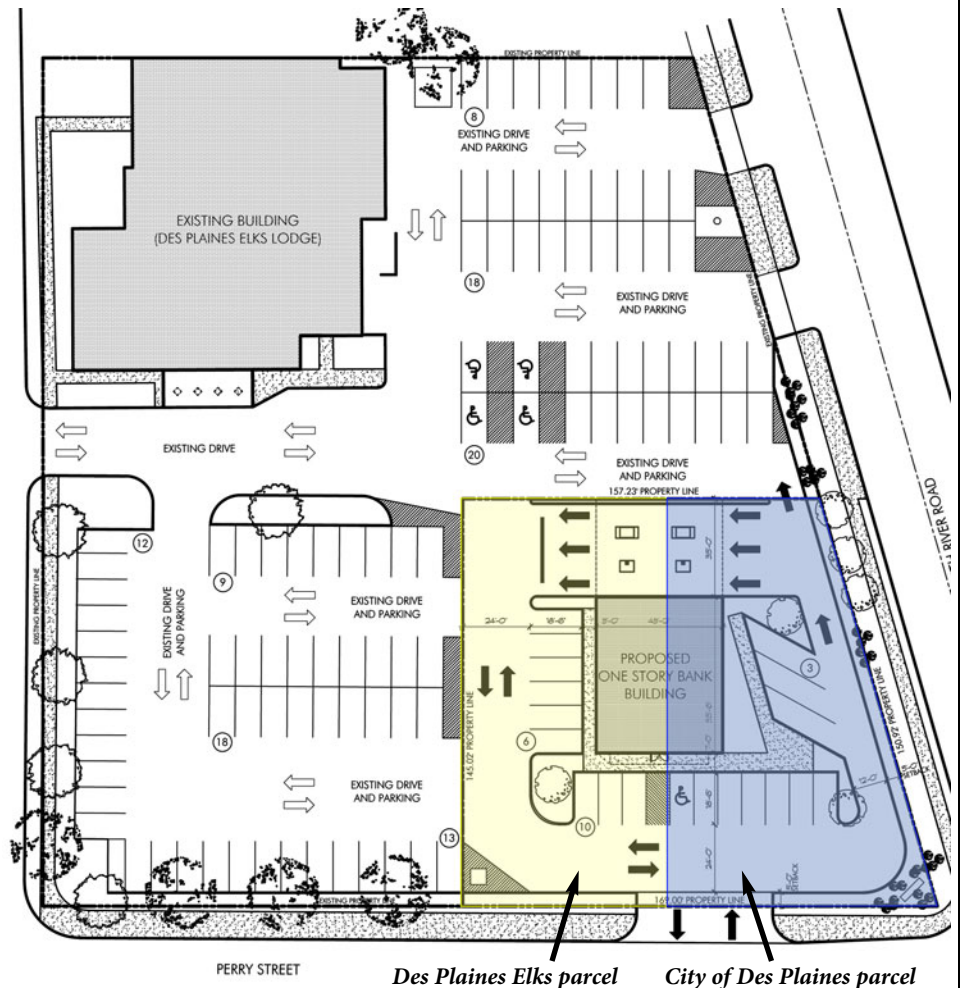

al is attached and a larger site board will be on display at the lodge for your review.

*Editor comment: The financial institution is slated to be Chase Bank.*

The above rendition was furnished by the developer. The Elks/City separated shaded areas were determined by a Google satellite map and are approximate.

## Reaction to Parking Lot Proposal

A preliminary discussion was held at the Sept. 20 lodge meeting. Reaction was mixed, but heated at times.

Earlier that meeting, member David Huber of Huber Financial reported on the financial health of the Des Plaines Lodge. Huber Financial has managed the Des Plaines Elks investments for over 10 years, and arguably has weathered lodge investments very favorably despite economical downturn and market instability.

When asked his opinion of the proposal, Mr. Huber did not comment favorably or unfavorably, but believed an unsolicited offer may not be the best offer available and required further investigation.

Exalted Ruler, Dan Burns spoke favorably of the offer, reminding the membership that the lodge is desperately in need of funding to refurbish both the interior and exterior of the building.

Board of Directors Chmn. Gerald Smith estimated the refurbishing cost at \$350,000.

Treasurer Dale Multerer offered that the Des Plaines Elks are not at this time in a financial position requiring liquidation of lodge real estate assets.

Director Dudley Parenteau suggested the possibility of maintaining the property and leasing the parcel to a builder for a 25-year period.

It was suggested that the lodge consider purchasing the corner property from the City of Des Plaines.

In any case, the Trustees will need to have an appraisal of the value of the entire property, the value of the proposed parcel, the value of the city's parcel, and the value of the Des Plaines Elks property less the proposed parcel if it were sold.

Lodge members are urged to attend the Oct. 18 meeting.

## Elks Hoop Shoot™

**2011 Elks Hoop Shoot**  
**Saturday December 3, 2011**

By Lori Lichter, Youth Activities Chair

All members are invited to volunteer for the Elks Hoop Shoot annual free-throw contest. We need referees, scorers, rebounders, admission form administrators, and food service help.

The winners of this contest advance to District; winners of District advance to State, Regional, and National contests. The national contest winners receive scholarships and awards.

Please help out and show your support for these kids. Free coffee and donuts will be available when you arrive at 8:30 am. The last round of shooters is usually around noon. If you have any questions or if you would like to volunteer please contact Lori at (312) 519-8567.

## Welcome New Members!

Nine American Citizens were initiated into Elkdom at the lodge meeting on Tuesday, Sept. 6, 2011. **Congratulations and Welcome New Members!**

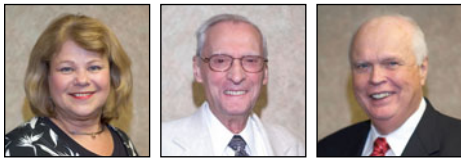

Anita Petrick, Anthony Angelico, Ed Hutchinson

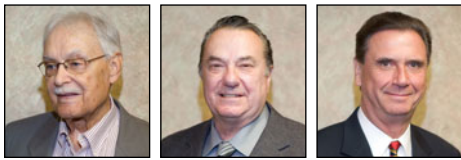

Frank Bieniek, Frank Merkendorfer, Gerald Stone



John Smyth, Paul Birch, Sara Lee Rodgers Schmidt

## Attention New Members!

Congratulations on your initiation into the Des Plaines Elks Lodge. We hope to see you around the lodge soon and often. In fact, we'd love to see you at our next meeting. As an incentive for new members to attend lodge meetings, we're offering to return your \$50 application fee—well, almost. For every meeting you attend this year, you'll receive a \$10 gift certificate redeemable at the Elks Club restaurant. You can receive up to five \$10 gift certificates! Check the meeting schedule on page two and plan to attend! We look forward to seeing you soon!

## Des Pl. Elks Veterans Meeting

By Aug Schwiesow

The third meeting of our lodge Veterans Group was held on Friday, Sept. 16, 2011. I must say, it was, a most interesting presentation by two of our Lodge members, Paul and David Fischer. (Below: Paul, Aug, Dave)



They dressed in period uniforms, one Union, the other, Confederate, and brought with them an interesting display of Civil War swords, uniforms and weaponry. John

Smullen, also a lodge member brought a Burnside carbine that came from the battlegrounds of the Civil War.

Of primary interest is that during the Civil War, 1860–1865, over 618,000 of our young men lost their lives in combat or from disease. This number of casualties is greater than our losses in all wars from the Revolutionary War to present conflicts. Our casualties during the Civil War were: Union 360,222, and Confederate, 258,000.

In one battle at Franklin, Tennessee, November 30, 1864, General Hood's Confederates lost over 6,000 of 21,000 troops, most of them in about two hours. Six Confederate Generals died at Franklin. This does not include the Union troops who also died here. The record loss was by the 1st Maine Heavy Artillery, in a charge at Petersburg, Virginia, June 18, 1864, which lost 635 of its 900 man unit within seven minutes.



A DVD was played with photos from a recent Civil War reenactment, which included photos of the CW museum at Lakewood Forest Preserve and many B+W photos taken during the CW conflict. This DVD is available from Aug for use by any fraternal group interested.

The Des Plaines Elks Veterans meeting was once again well received by our group and future meetings are planned quarterly, any veteran with a story to tell is invited to be our guest speaker. We invite all veterans to participate and encourage them to become members of our Lodge.

To volunteer as a guest speaker, please email me at: [aug.schwiesow@illinois-elks.org](mailto:aug.schwiesow@illinois-elks.org) or call 847-635-1503.

## Door Greeters

To reschedule your date, please call Sara Lee Rodgers Schmidt at (847) 395-8605. Greeter hours are 5:30–7:30 pm.

Fridays	Saturdays
10/07 Don Kellerman	10/01 Ruth Olson
10/14 Louis D'Attomo	10/08 Lee Herron
10/21 Don Kellerman	10/15 Dan Fluett
10/28 Gloria Markiewicz	10/22 Louis D'Attomo
	10/29 Lee Herron

## Resolutions

cont. from pg. 2

6. To remove references to the Communist Party and include all organizations advocating the violent or forcible overthrow of the government. Yes: 2400 No: 799
7. To delete Grand Lodge committees and create a new Activities Committee. Yes: 1825 No: 1372
8. To delete Grand Lodge committees and create a new Fraternal Committee. Yes: 1902 No: 1293
9. To conform the subordinate lodges' committees and programs to those of the Grand Lodge. Yes: 2058 No: 1132
10. To replace the word "Subordinate" with the word "Local" throughout the Constitution and the Laws of the Order. Yes: 2408 No: 788 75.16%
11. To delete the requirement of a January District Deputy clinic. Yes: 2385 No: 808
12. To provide for lowest coach fares rather than first class for travel. Yes: 2950 No: 246
13. To delete the requirement that District Deputies attend the Grand Lodge session. Yes: 795 No: 2399
14. To delete the requirement that District Deputies witness and report on the lodges' exemplification of the initiatory Ritual. Yes: 1868 No: 1328
15. To replace the word "Grand" with the word "National" throughout the Constitution and the statutes enacted by Grand Lodge. Yes: 1040 No: 2154 32.46%
16. To delete positions, add two new positions, and provide for a new method of selecting the Grand Exalted Ruler. Yes: 1053 No: 2141 32.87%
17. To provide for the Grand Vice-President to become the Grand Exalted Ruler automatically. Yes: 1398 No: 1796 (void if 16 fails)
18. To streamline and re-structure the committees of the Grand Lodge. Yes: 1994 No: 1202 (void if 7 & 8 fail)
19. To allow Subordinate Lodges to have only one meeting per month. Yes: 1624 No: 1572 (void if 20 & 21 fail)
20. To conform the statute to one meeting per month. Yes: 1593 No: 1603 (void if 15 or 21 fail)
21. To conform the statute to one meeting per month. Yes: 1591 No: 1603 (void if 19 or 20 fail)
22. To allow Homes, Clubs, Club Rooms, and Social Parlors to be open during Lodge meetings. Yes: 1119 No: 2079
23. To allow the assets of defunct Lodges to be split between a state major project and a state association. Yes: 2446 No: 746

continued

24. To eliminate mandatory funding for the Elks National Home. Yes: 1653 No: 1545 51.59%
25. To allow guest access cards for military personnel. Yes: 0 No: 0 (out of order)
26. To clarify that "charge" means a formal complaint in a Subordinate Forum. Yes: 2934 No: 261
27. To allow Subordinate Lodges to recognize affiliated organizations. Yes: 2226 No: 970 69.48%
28. To establish provisions relating to affiliated organizations. Yes: 2134 No: 1066 (void if 27 fails)
29. To increase the fee for replacing lost or destroyed Lodge Charters. Yes: 2532 No: 666
30. To establish a uniform master Lodge auditing and accounting program. Yes: 1119 No: 2076
31. To allow the State Sponsor to waive the requirements for an audit, review, or compilation. Yes: 1994 No: 1206
32. To allow the State Sponsor to waive professional preparation of Lodge tax returns. Yes: 2018 No: 1174
33. To clarify that a Board of Directors, made up of the Chair Officers and Trustees, shall govern incorporated Lodges. Yes: 2508 No: 688
34. To modify the duties of the Grand Secretary in making disbursements. Yes: 2547 No: 645
35. To permit the Committee on Judiciary to make non-substantive, conforming changes to the Laws of the Order. Yes: 2347 No: 838
36. To permit the electronic transmittal of The Elks Magazine. Yes: 2598 No: 588 ■

#### ER Article

*cont. from pg. 1*

More than 800 dictionaries were distributed to third graders from ten area schools. The kids are surprisingly happy to receive a real book—even in this age of electronic devices. Knowledge is certainly the key to success for our youth and we are happy to provide them with the dictionaries funded by the generosity of our members. Lori has also organized the school supplies and coat drives again this year. Thanks to all who have supported these events.

There are a few matters being seriously looked into by the lodge officers on behalf of the members. These items will be detailed in future meetings and the *Elks Tooth* for the members to be informed. The best way to understand what is happening is by attending meetings and voicing your opinion and possible concerns. Don't be left out—your

## What is the Des Plaines Elks Oktoberfest Raffle?

Every year, the Des Plaines Elks run an Oktoberfest raffle to benefit the "Elks Club," our restaurant and banquet facility. Funds raised are used for improvements like furniture upgrades, carpet replacement, ovens, freezers, and more.

Only one thousand Oktoberfest tickets go on sale every June for \$50/ticket; each ticket purchaser hoping he or she will win the **Grand Prize of \$10,000!**

Tickets can be purchased at the restau-

rant and bar, but the success of this program depends on ticket sales outside the lodge by the membership. **Members are encouraged to sell five tickets to family, friends, and co-workers.** Although everyone doesn't win a prize, odds are 1 in 48, with 21 prizes totaling \$25,000!

To consign five tickets to sell or to purchase an Oktoberfest ticket, see Club Manager Randy Menzies at the lodge or phone (847) 824-1526.

#### TICKET PRICE

Donation to Elks Club **\$50**

## OKTOBERFEST 2011

Annual Raffle of the Des Plaines Elks Club

**When: Saturday, October 29, 2011 – Grand Drawing at 9 pm**

**Where: Des Plaines Elks Lodge #1526**

**Attn Ticket Sellers:** We are extending the seller's rewards Gift Certificates until the drawing. **Sellers will receive one (1) ten-dollar gift certificate for every five (5) Oktoberfest tickets sold,** and will also be entered into the *Sellers' Raffle for cash prizes.* Contact manager Randy Menzies for details at (847) 824-1526.

vote counts—and is important to the future of the Lodge and Club operation.

Don't forget to check the lobby table as well as the *Elks Tooth* to keep informed of upcoming events; especially the Bears football games on Sundays. To have your *Elks Tooth* e-mailed, contact Lodge Secretary Don Bahr and provide him with your e-mail address. ■

## Fifty-Years-Plus Honorees

*By Jeff Basko, Committee Chmn.*

The 50-Years-Plus Membership Honorary Dinner will commence on Saturday, February 4, 2012 at 4 pm. The dinner will recognize members with 50 or more years membership in good standing with our lodge.



The Lodge Secretary's records will determine members who qualify for the dinner, and will receive invitation by mail. The dinner is complimentary for honorees and only \$15 per person for members and guests.

A family-style dinner will be served at 5 pm, plaques will be presented to the honorees thereafter dinner.

Members are encouraged to attend and support our members with such loyal tenure.

## Warm Hugs for the Winter

*By: Lori Lichter, Youth Activities Chair*

This year's Warm Hugs program will begin collecting new and used hats, gloves, scarves, and coats for donation to organizations working directly with needy families in our community.



Your donations can help make this winter warm and comfortable for those in need. Please bring your donations to the Lodge before October 31. Collected items will be presented to the organizations the following week.

## A Holiday of Hope

*By: Lori Lichter, Youth Activities Chair*



The *Holiday of Hope* program is a holiday fundraising program for those less fortunate in our local area. Funds will be forwarded to the *Self-Help Closet & Pantry of Des Plaines* which will then identify families to benefit from this program. Send your donation to the Lodge Secretary with "Holiday of Hope" in the memo space.

Des Plaines Elks Club Annual Fundraising Raffle

# Oktoberfest 2011

## Celebration and Grand Drawing

Saturday, October 29, 2011



### *Dining Room Specials:*

Rouladen of Beef, Weiner Schnitzel, and Sauerbraten

### *Banquet Hall Special:*

**Farmers Sausage Buffet from 6 to 8 pm for only \$15**

*Buffet includes: Bratwurst, Thuringer, Knockwurst,  
German potato salad, potato pancakes, red cabbage, pretzels,  
pickles, mustards, sauerkraut, and apple strudel!*

***Music for Listening & Dancing provided by Larry Hulina***

from 8 pm to 11:30 pm downstairs.  
Tickets will be available at the main bar.



## Grand Drawing

## Grand Prize: \$10,000

### \$25,000 Total in Prizes

**Grand Drawing: Saturday, October 29, 2011 at 9 pm.**

*Come Enjoy the Fun!*

# ELKS CLUB

(847) 824-1556 reservations  
 (847) 824-2036 fax  
 Randy@DesPlainesElksClub.com



Randy Menzies  
 Elks Club Manager



## Manager's Message *by Randy Menzies, Club Manager*

The \$3,500 Oktoberfest Earlybird winner was ticket #0179, sold to Alyssa Bahr, by Don Bahr. Congratulations. We have 650 tickets sold to date. We need *your* help to have a successful Oktoberfest. Sell five tickets and you'll be automatically entered into the Sellers' prize raffle AND receive a \$10 gift certificate good at the Club.

**Glenview Fall Golf Outing—Thursday, October 13.** \$75.00 per golfer includes 18 holes of golf, a golf cart, lunch on the turn, prizes and dinner with a cocktail at the Lodge. Sign up at the main bar with payment in full or call me Randy 847-824-1556.

**The Oktoberfest Main Event & Drawing is Saturday, October 29.** This year's Oktoberfest features several authentic German dishes in the main dining room including Rouladen of beef, Sauerbraten, Wiener schnitzel, and homemade potato pancakes.

**The Banquet Hall will have a Farmers Sausage Buffet from 6:00–8:00 pm** for only \$15.00 per person. Tickets are available at the main bar. The buffet includes Brats, Thuringer, Knockwurst, German potato salad, Potato pancakes, red cabbage, Spaetzle, sauerkraut and apple strudel. Music will be provided by Larry Hulina from 8-11:30 pm in the Banquet Hall.

**Turkey Shoot, Thursday, November 17.** Open at 11 am. All-day raffles for Turkeys, Cash, and Liquor. Bring your dollars and win a turkey or a bottle. Complimentary turkey sandwiches at 3 pm.



**NFL football featured on Sundays at the Elks** from 11:30–6:00 pm. Time may be adjusted for Bears games. Food may be purchased at the bar. We have great seats to watch the Bears or your favorite football game. **Sunday football beer specials:** Buckets of Miller (5 bottles) for \$12.50; draft pints only \$2.00.

**NOTE:** The club will be closed on Sunday, Oct. 9, (open for MNF the following night), and Sunday, Oct. 30 (Bears bye week).

**DJ Tony's repertoire features 50s, 60s, & 70s dance songs.** Tony will be at the Club on Friday, October 7th and 28th, November 4th and 25th, and December 2nd.

## MNF Lions vs. Bears



**Bears at Lions.** The Club will be open Monday night, October 10 at 6:00 pm, game time is at 7:30 pm. The Lions are a much improved team and this matchup has potential to be a great game!

### *Manager's Presentation*

#### Saturday Evening Specials

October 01: **Dover Sole 16-oz.** . . . . . 18.95  
*Sautéed to a golden brown Almandine*

October 08: **Beef Rouladen** . . . . . 13.95  
*Rolled Beef stuffed duxie mushroom, pickle, and Grain mustard*

October 15: **Mixed Grill** . . . . . 13.95  
*Swordfish, Halibut and Salmon with garlic mashed potatoes*

October 22: **Weiner Schnitzel** . . . . . 14.95  
*Sautéed to golden brown, served with Spatzel*

October 29: **Sauerbraten & Spatzel** . . . 13.95  
**Beef Rouladen** . . . . . 14.95  
**Weiner Schnitzel** . . . . . 15.95

#### Drink Specials

Tuesday: Dream Sickle . . . . . \$4.00  
 Orange and Vanilla Smirnoff Vodka  
 Wednesday: Smirnoff & Cherry Cola . . 4.00  
 also reg. Cola or Diet Cola  
 Thursday: Raspberry Vodka &  
 Lemonade . . . . . 4.00  
 Friday: Apple Martini . . . . . 4.00  
 Saturday: Smirnoff Citrus Martini . . . . 4.00  
 Korbel Splits . . . . . 5.00

#### Daily Beer Specials

Tuesday: Draft Beer Day . . . . . Tap - 1.25  
 Old Style, Leine Red, Miller  
 Light, Pabst Blue Ribbon  
 Wednesday: MGD . . . . . Bottle - 2.00  
 Thursday: Coors Light . . . . . Bottle - 2.00  
 Friday: Peroni (import) . . . . . Bottle - 2.00  
 Saturday: MGD 64 . . . . . Bottle - 2.00

#### Find Your Lucky Member Number!

If your member number appears in a sponsored ad or Club ad, stop by the Club and receive a \$10 gift certificate – good any-time at the Club!  
**Good Luck!**

# Club'N with *Hey Tony!* Tony the DJ

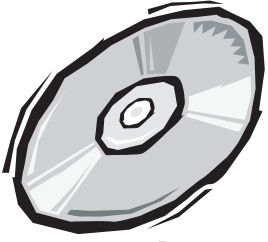

Friday, October 7 and Oct 28 from 8 pm to 11 pm - No cover!

Also on the following Fridays: Nov. 4 & 25 / Dec. 2

We want to be YOUR  
Friday Night Lights!



## Dance Club • Rock Club • Oldies

(where "oldies" mean '70s NOT '40s)

you will be cautiously permitted to make noise

**NOISE  
THIS!**

you jus come

*say what?*

bring your air guitar and plugin  
s-c-h-w-a-n-n-n-g

*Club-Like Atmosphere -*

*Trendy Drinks at the Bar*

*including premium Vodkas,*

*Martinis and Tofu Popper-*

*Whappadoos!*

**BEER!!**  
*slurp-burp*

## Popper-Whah?

don't you DARE bring ur daddy back here!

*Banquets at the Des Plaines Elks Club*  
**Presenting Our Complete Package Menu**

**Including Four Hours of Open Bar**

**Package Menu includes:** Choice of Entrée, with choice of Appetizer, Vegetable, Potato, and Dessert; or Family Style  
**Also includes:** Four-Hours of "Better-Brands" Open Bar Service with Unlimited Champagne or Wine with Dinner

**Appetizer Choices**

Tropical Fruit Supreme, Soup of the Day, French Onion Soup,  
 Shrimp Cocktail (+2.75), Fresh Fruit Plate (+1.75)

**Choice of Entrée**

- Filet & Chicken Breast Combination . . . . . \$39.00**  
*This tasty combination is topped with demi Bordelaise sauce accompanied by angel hair pasta & tomato broccoli garni*
- Roast Beef Tenderloin Briand . . . . . \$37.00**  
*Slices of Beef Tenderloin baked to perfection served with duchess potato & topped with Bordelaise sauce & tomato garni*
- Roast Prime Rib au jus . . . . . \$39.00**
- Filet Mignon with mushroom cap . . . . . \$43.00**

**Vegetable Choices**

Peas & mushrooms, green beans with almonds or mushrooms,  
 fresh candied carrots, steamed broccoli,  
 or Chef's Blend (Broccoli, Carrots & Squash)

**Potato Choices**

Baked potato, Duchess, parsley-boiled, oven brown, mashed,  
 Potatoes Anna, double-baked, or rice pilaf

**Family Style**

**Family Style choice of Ham or Beef Roast and Fried or Baked Chicken . . . . . \$39.00**  
*Includes mashed potatoes & gravy, vegetable and choice of sauerkraut and sausage or mostaccioli*



*pictured with optional chair covers*

- Ribeye Steak tender & tasty served with onion ring . . \$36.50**
- New York Strip Steak topped with mushroom cap . . \$36.50**
- US Choice Butt Steak . . . . . \$36.50**  
*Center cut topped with mushroom cap*
- London Broil served with mushroom sauce . . . . . \$36.50**
- Roast Sirloin of Beef au jus . . . . . \$36.00**
- Orange Roughy served with lemon butter . . . . . \$36.00**
- Baked Scrod served with Almandine sauce . . . . . \$36.00**
- Lake Superior Whitefish served with lemon butter . \$36.00**
- Roast Turkey with dressing and cranberry sauce . . . \$34.00**
- Chicken Marsala . . . . . \$36.00**  
*Chicken breast with mushrooms and wine sauce*
- Herb Chicken Breast . . . . . \$35.50**  
*Delicately seasoned chicken breast served with a fine herb sauce & angel hair pasta*

**Dessert Choices**

Sherbet, Crème de Menthe, Chocolate or Strawberry Sundae  
 (or Parfait), Peach Melba, Chocolate or Strawberry Mousse

**Beverage Choices**

Coffee or Tea

**Extras**

**Hors d'oeuvres - Hot & Cold Combination . . . . . \$2.50**

BBQ Meatballs, Egg Rolls, Cocktail Franks, Onion Rings,  
 Cheese Tray, Relish Tray & Chips with Dip

**Cake or Sweet Table . . . . . call for details**

*Prices Shown Include Your Complete Dinner, Four Hour Bar, Gratuities, Skirting of Head & Cake Table, Candelabras, Microphone & PA System*

*Above prices include 18% gratuity. 11% tax is added to above prices. Special menu items are available; please call Manager Randy Menzies at (847) 824-1556 to book your event.*



# Breakfast with Santa Claus

**Sunday, December 11, 2011**

For children ages 2–10. Serving begins at 10 AM. Limited to 200 people.  
Complimentary professional photograph of your child with Santa Claus.

**Children's Menu - No Charge** - Cereal, pancakes, sausage, hash browns, milk, juice

**Adult Menu - \$12.00** - Scrambled eggs with bacon or sausage, pancakes, cereal, hash browns, sweet rolls, juice, milk, coffee or tea.

**Fruit on the Table** - Cantaloupe, oranges, bananas, toast & jelly.

**This Reservation Form is Required.**

## "Breakfast with Santa" 2011 Reservation Form

Number of Adults: \_\_\_\_\_ × \$12.00 / Adult

How many children will be attending in each age/boy/girl bracket.

No. of Children:	Age 2-3	Age 4-5	Age 6-7	Age 8-9
Boys	_____	_____	_____	_____
Girls	_____	_____	_____	_____

Member Name \_\_\_\_\_ Member Number \_\_\_\_\_

Phone Number(s) \_\_\_\_\_

*Child must be present to receive a gift from Santa.*

**This Reservation Form must be submitted to the Lodge Office, with Payment in Full (cash or check) prior to December 1, 2011. All participants must reserve in advance. Tickets will NOT be available at the door!**

*Name tags will be issued to children upon arrival.*

## Losing a Loved One.

You feel at your worst, but have so much to plan.  
Let us help simplify your luncheon.

The Des Plaines Elks Club is available Monday through Saturday for any type of luncheon or dinner following a funeral or memorial service. Our Club is renowned for its pleasant atmosphere and good food.

Our facility accommodates 25–250 people and is located only minutes from All Saints Cemetery, Ridgewood Cemetery, and Memory Gardens. Complete bar service is available. And, you're billed only for the number of attendees.

### Funeral Luncheon Menu

Roast Prime Rib of Beef .....	\$14.95
Roast Sirloin of Beef Au Jus .....	12.95
Seasoned Boneless Chicken Breast .....	12.95
Broiled London Broil .....	12.95
Family Style Beef, Chicken and Mostaccioli	
All-You-Can-Eat .....	14.95

*All entrées include rolls and butter, salad, potato or pasta, vegetable, desert, and Coffee or tea. Bar service is available. All prices add 18% gratuity plus 11% tax.*

**Des Plaines Elks Club** 495 Lee Street, Des Plaines, IL 60016  
tel 847 824-1556 | fax 847 824-2036

## Des Plaines Elks Wednesday Night BINGO

**Doors open at 4 pm / Earlybird game starts at 6:45 pm**  
**20-game cards - \$20**  
**12-game cards - \$13**  
**daubers low as \$1**

- 15 Games of Bingo
- \$500 Jackpot Gm#15
- Bonanza
- 3-Game Progressive
- Split-the-Pot

## Be Part of a Fraternal Organization Like No Other

### Wills and Bequests

One significant way to support the Des Plaines Elks Lodge #1526 is to include the Lodge in your will. Large or small, these gifts are vital to the success of the Des Plaines Elks efforts to inspire future generations to care about our children, our veterans, our community, and those less fortunate.

If you're planning to make the Des Plaines Elks Lodge #1526 one of your beneficiaries, we encourage you to let us know. Prior notification helps us to work with you and your advisers to achieve your philanthropic goals. Your information will be kept confidential, and you may remain anonymous for donor recognition purposes.

### A message from an anonymous donor:

*"I've included the Des Plaines Elks Lodge in my will because I want the Lodge to be around for future generations."*

### A Simple Gift

Gifts through wills and living trusts are popular because they are easy to arrange and may be changed at any time you choose. A provision or amendment prepared by your attorney at the time you make or update your will is all that is necessary.

For more information, please contact the Lodge Secretary at (847) 824-1526. ■

# October Events

SUNDAY	MONDAY	TUESDAY	WEDNESDAY	THURSDAY	FRIDAY	SATURDAY
<b>Saturday Lunch Special 6-oz. Burger \$2.95</b> <b>Friday Fish &amp; Shrimp Specials \$7.95-\$9.95</b>						<b>1</b> Roast Leg of Lamb 13.95 Music & Dancing Ed Knaak Duo
<b>2</b>  Game time: Noon Club open 11:30 am-6 pm Bar menu available	<b>3</b> Club Closed	<b>4</b> Danish Lobster 15.95 10 oz. New York Strip Steak 10.95 Lodge Mtg. 7:30 pm	<b>5</b> Fried Chicken 6.95 Black Angus 8 oz. Burger Special 6.95 Bingo 7 PM	<b>6</b> All You Can Eat Filet of Sole 7.95 Prime Rib 11.95 BBQ Pork Ribs Full Slab 12.95	<b>7</b> All you can Eat Battered Cod 9.95 Broiled Scrod 9.95 Ocean Perch 7.95 Coconut shrimp 9.95 Tony D J	<b>8</b> Beef Wellington 14.95 Music & Dancing Lavern & Paul
<b>9</b> Club Closed	<b>10 MNF</b>  Game time: 7:30 pm Club open 6-10 pm Bar menu available	<b>11</b> Danish Lobster 15.95 10-oz. Butt Steak 10.95 Trustee Mtg. 7 pm	<b>12</b> Fried Chicken 6.95 Black Angus 8 oz. Burger Special 6.95 Bingo 7 PM	<b>13</b> All You Can Eat Filet of Sole 7.95 Prime Rib 11.95 BBQ Pork Ribs Full Slab 12.95	<b>14</b> All you can Eat Battered Cod 9.95 Broiled Scrod 9.95 Ocean Perch 7.95 Coconut shrimp 9.95 Jim Boyd	<b>15</b> Alaskan King 1 lb. Crab legs 16.95 Vince Micari Jr.
 Game time: 7:20 pm Club open 3 pm-10 pm Bar menu available	<b>17</b> Club Closed	<b>18</b> Danish Lobster 15.95 Rib Eye Steak 10-oz. 10.95 Lodge Mtg. 7:30 pm	<b>19</b> Fried Chicken 6.95 Black Angus 8 oz. Burger Special 6.95 Bingo 7 PM	<b>20</b> All You Can Eat Filet of Sole 7.95 Prime Rib 11.95 BBQ Pork Ribs Full Slab 12.95	<b>21</b> All you can Eat Battered Cod 9.95 Broiled Scrod 9.95 Ocean Perch 7.95 Coconut shrimp 9.95 Tony DJ	<b>22</b> 8-oz. Lobster Tail 17.95 Music & Dancing John Matt Trio
<b>23</b>  Game time: Noon Club open 11:30 am-6 pm Bar menu available	<b>24</b> Club Closed	<b>25</b> Danish Lobster 15.95 10-oz. Skirt Steak 10.95 Director Mtg. 7:00 pm	<b>26</b> Fried Chicken 6.95 Black Angus 8 oz. Burger Special 6.95 Bingo 7 PM	<b>27</b> All You Can Eat Filet of Sole 7.95 Prime Rib 11.95 BBQ Pork Ribs Full Slab 12.95	<b>28</b> All you can Eat Battered Cod 9.95 Broiled Scrod 9.95 Ocean Perch 7.95 Coconut shrimp 9.95 Paul Adams.	<b>29 Oktoberfest Grand Celebration &amp; Drawing</b> German Specials Music & Dancing Chuck Masny
<b>30</b> Bears Bye Week Club Closed	<b>31</b> Club Closed	<b>1</b> Danish Lobster 15.95 New York Strip Steak 10.95 Lodge Mtg. 7:30 pm	<b>2</b> Fried Chicken 6.95 Black Angus 8 oz. Burger Specials 6.95 Bingo 7 PM	<b>3</b> All You Can Eat Filet of Sole 7.95 Prime Rib 11.95 BBQ Pork Ribs Full Slab 12.95	<b>4</b> All you can Eat Battered Cod 9.95 Broiled Scrod 9.95 Ocean Perch 7.95 Coconut shrimp 9.95 Tony DJ	<b>5</b> Steak Diane 13.95 Music & Dancing Ed Knaack

THE DES PLAINES ELKS CLUB RESERVES THE RIGHT TO WITHDRAW OFFERS DUE TO TYPOGRAPHIC ERRORS.

Complimentary Hors d'oeuvres 5-7 pm Friday & Saturday in the Lounge

For Dinner Reservations, Phone (847) 824-1526

**SULLIVAN & JOHNSON LTD**  
 CERTIFIED PUBLIC ACCOUNTANTS

- Individual Tax Returns
- Estate & Trust Taxes
- Corporate & Partnerships



AMY J. SULLIVAN C.P.A.  
 CRAIG D. JOHNSON C.P.A.  
**(847) 759-6100**  
 1420 Renaissance Drive, Suite 205  
 Park Ridge, Illinois 60068



6269



**Lippers Carpet Cleaning**  
 Carpet & Upholstery  
 Residential • Commercial • Auto

**Dave Lipp**  
 Off-Duty Fireman (773) 244-9027

**Frank's Home Repair**

Frank Witkus 847 894-0359

- Free Estimates
- Interior Painting
- Exterior Painting
- Plumbing
- Maintenance
- Electrical
- Honey-Do List
- Minor Remodeling
- Door and Window Replacement
- Free Fishing Tips

"I will repair what you have attempted"

**Assured Caregiver Services, LLC**

960 Rand Road, Suite 108  
 Des Plaines, IL 60016  
**Phone: (847) 827-2778**



**Hourly or Live-in Companion Services**  
 Licensed by Illinois Department of Public Health

[www.assuredcaregiverservices.com](http://www.assuredcaregiverservices.com)

- ♥ assistance with hygiene ♥ laundry services
- ♥ errands & transportation
- ♥ medication reminders ♥ meal preparation
- ♥ light housekeeping

Caregivers are background checked and insured.

**Ask Your Friend to Become an Elk  
They'll be Glad You Did!**

**In-Home Non-Medical Care**

*Non-medical and personal care*

Care plans tailored to  
your needs and budget



**Tom Merlin**  
(847) 685-0593

*Free In-Home  
Consultation*

Each office is independently owned & operated.

**Support Our Sponsors—They're Members!**

Cabinets	Bathrooms	Kitchens
Rec. Rooms	Plumbing	Ceramic
Electrical		Custom Tile

**Jeff Lipman Construction, Inc.**

*Quality is our game!*

**Jeff Lipman** Jeff@LipmanConstruction.com  
(847) 657-8990 Whirlpool Tubs  
Cell (847) 208-8998 Custom Tops

10548

www.ElksTooth.com

# October Elks Tooth Newsletter



330 E. Northwest Highway, Mt. Prospect, IL 60056  
Office: (847) 259-0202 [www.JimGradyHomes.com](http://www.JimGradyHomes.com)  
E-mail: James.Grady@comcast.net

**RE/MAX®**  
**Suburban**  
**Jim Grady, GRI**  
**Broker/Manager**

*Whether you're buying or selling  
a home, choose RE/MAX Suburban  
for the professional edge.*



**Des Plaines—Stunning, Classic Cumberland Cape Cod!**  
Brick, plaster and beautiful hrdwd flrs in this updated 2-story  
3BR/3BA. 3 blks to Cumberland Metra and YMCA. 1st flr Fam  
Rm addition designed for future Master Ste/In-law set-up.  
Fabulous Kitchen! Finshd basemnt, PLUS wonderful 23x15  
heated studio in backyard! **\$379,900** ▶

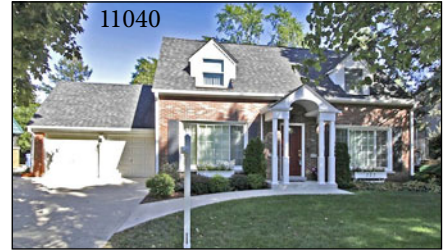

**Des Plaines—Brickman Ranch!**  
Great, updated 2BR/2BA home with newer windows, roof,  
kitchen and bath. 3rd bedroom used as dining room. Finished  
basement with full bath. No water here! Flood control in front  
yard. Shows great! 2 car detached garage. **\$205,000** ▼



**Rolling Meadows—Affordable and Convenient! \$99,000** ▲  
Very nice 2BR/1BA corner unit on second floor of updated,  
elevator building. Unit shows great, updated Kitchen and  
Bath, quiet area. Lovely views from new balcony. Low  
assoc fee includes heat, water, and gas. Plenty of parking.

NON-PROFIT ORGANIZATION  
US POSTAGE PAID  
PERMIT NO. 7, DES PLAINES, IL

Des Plaines Elks Lodge No. 1526  
495 Lee Street  
Des Plaines, IL 60016

PHONE: (847) 827-2181  
FAX: (847) 390-7643

**DANIEL J. DOWD**  
*Attorney at Law*

DOWD, DOWD & MERTES, LTD.  
701 LEE STREET, SUITE 790  
DES PLAINES, ILLINOIS 60016

Wall-to-Wall Carpet • Area Rugs • Oriental Carpets Repaired  
and Refringed • Binding Service • In-Plant Area Rug Cleaning

**EDGEWATER CARPET  
& RUG, INC.**

*Family Owned & Operated Since 1926*

**(773) 763-5533**

Mark & Linda Hachigian 6664 Northwest Highway  
www.edgewatercarpet.com Edison Park, Chicago

*Your "Long Arm" of the Law*

**Raymond J. Bayster**  
*Attorney and Counselor at Law*

44 Park Lane, #236  
Park Ridge, Illinois 60068  
Phone: (847) 823-0106